



Finding Your HPI Facility Code in Medtech Evolution

Why It Matters

HPI Facility Codes are issued by Health New Zealand and are location-specific identifiers. Each facility location in Medtech Evolution has a unique HPI code, which ensures integrations (like the AI Scribe via ALEX®) connect to the correct site.

01 Open Medtech Evolution

Navigate to the Evolution button in the upper left-hand corner and select Options.

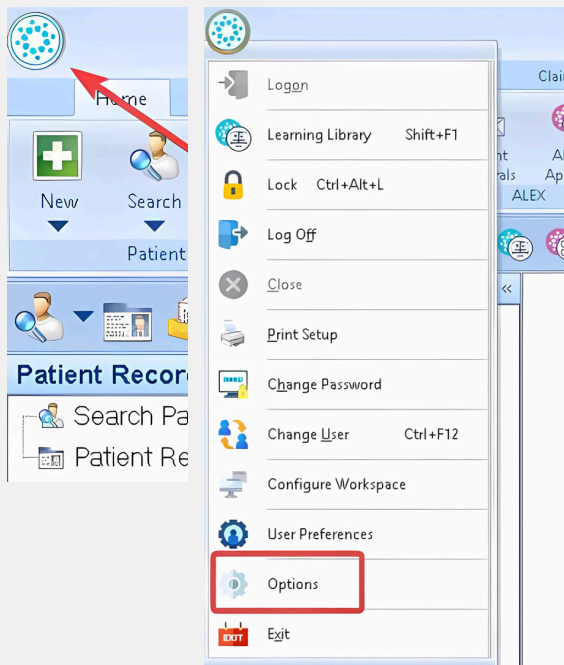

02 Select Location Settings

In the Options menu, choose Location → Location Settings.



03 Choose the Location

From the list of locations, select the site you want to check.



04 Open Codes & Defaults

In the location details window, click the Codes & Defaults tab.

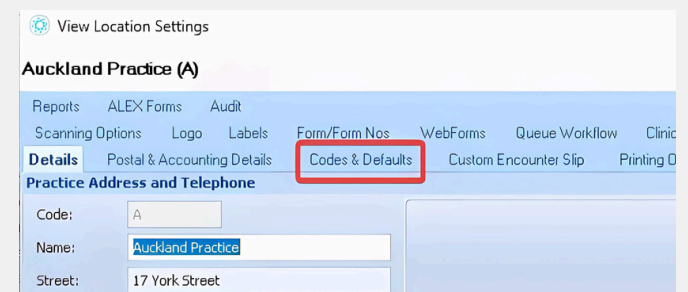



01 Locate the HPI Facility Code

The HPI Facility No. is displayed on the right side of the window.

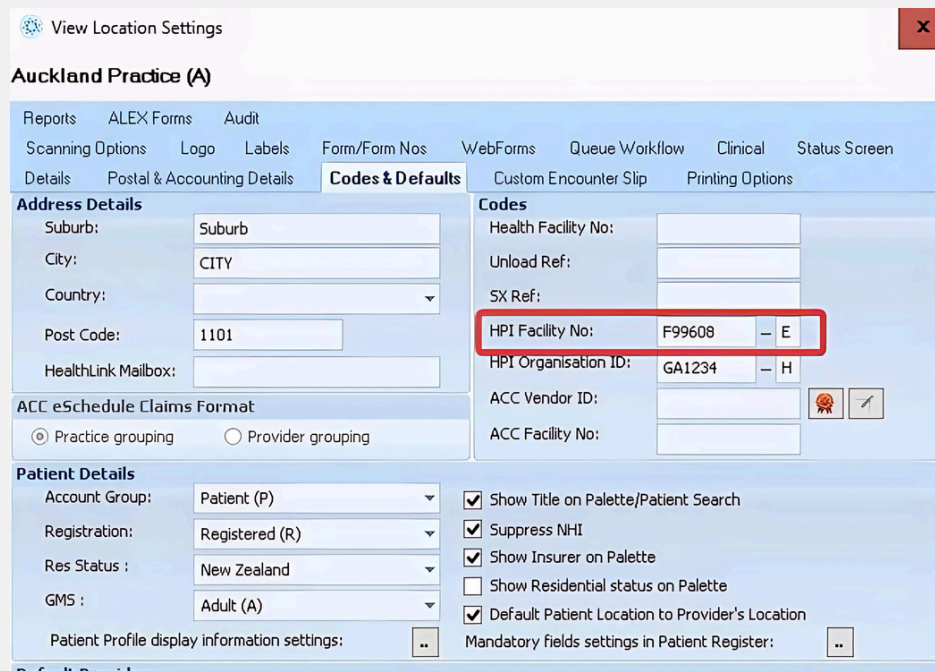

The screenshot shows the 'View Location Settings' window for 'Auckland Practice (A)'. The 'Codes & Defaults' tab is selected. In the 'Codes' section, the 'HPI Facility No.' field is highlighted with a red box and contains the value 'F99608 - E'. Other fields include 'Health Facility No.', 'Unload Ref.', 'SX Ref.', 'HPI Organisation ID: GA1234 - H', 'ACC Vendor ID', and 'ACC Facility No.'. The 'Address Details' section includes fields for Suburb, City (CITY), Country, Post Code (1101), and HealthLink Mailbox. The 'ACC eSchedule Claims Format' section has radio buttons for 'Practice grouping' (selected) and 'Provider grouping'. The 'Patient Details' section includes dropdowns for Account Group (Patient (P)), Registration (Registered (R)), Res Status (New Zealand), and GMS (Adult (A)), along with checkboxes for 'Show Title on Palette/Patient Search', 'Suppress NHI', 'Show Insurer on Palette', 'Show Residential status on Palette', and 'Default Patient Location to Provider's Location'.

Tip: Be sure to include the entire code, including the single letter at the end, when sharing with an integrating partner.

Need Help?

- Medtech Support: 0800 263 3832
- Email: support@medtechglobal.com

Contact Continuity

- If you need assistance beyond the HPI code, please contact your IntelliTek Health representative or email cva.sales@intellitekHealth.com